

# DIO-52ZW Z-Wave DI/DO Module

## Improves Process Efficiency



- One Digital Input (DI) and one Digital Output (DO)
- Integrates wired devices into Z-Wave networks
- Battery-powered, AC-powered, or DC-powered

The DIO-52ZW is a Z-Wave DI/DO module that integrates wired devices into Z-Wave wireless networks to create automated responses and enhance security and convenience. Providing a digital input (DI) and a digital output (DO) that connect to wired devices, the DIO-52ZW serves as a bridge of reliable and fast communication between a security system and wired devices over Z-Wave network.

The DIO-52ZW turns the device connected to its DI point into the trigger of events, and its DO point into the responder of events. Open it, close it, turn it on, turn it off, wirelessly remotely activate or obtain data from devices that are hard to reach. Devices commonly connected are smoke detectors, PIR motion sensors, door/window contacts, garage doors, motorized shades, gates, or valves.

Interoperable with other manufacturer's Z-Wave systems, the DIO-52ZW can be flexibly incorporated into new or existing smart home security systems, to further improve process efficiency and safety for the entire home.

### Features

- One Digital Input (DI) and one Digital Output (DO)
- Dry contact input forms Normal Open (NO) or Normal Close (NC) loop
- Turns the device connected to the DI into the trigger of events
- Turns the device connected to the DO into the responder of events.
- LED Status Indicator
- Obtains data from and activates remote field devices that are wired or hard to reach
- Establishes reliable and fast communication between a control system and remote field devices over Z-Wave network
- Compatible with other manufacturers' Z-Wave systems
- CE compliance

### Examples of DI/DO Architecture

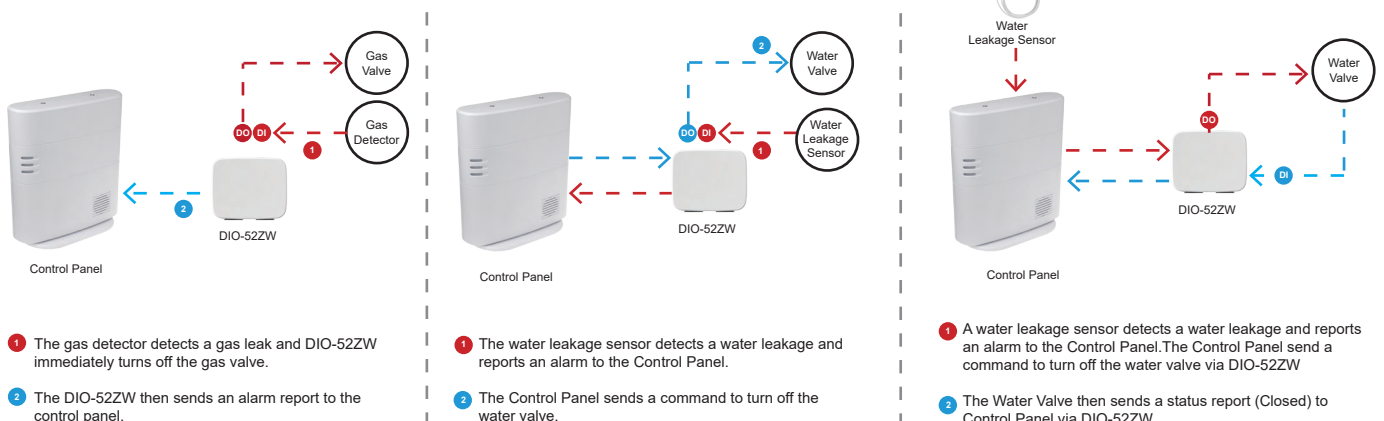

## DIO-52ZW Z-Wave DI/DO Module

### Specifications

#### DIO-52-AC-ZW

Communication Protocol	Z-Wave Plus 700 Series
Frequency	868.40 MHz (EU) / 908.40 MHz (US)
Power Terminal	100V ~ 240V AC
Backup Battery	4.8V, 600mA Rechargeable battery pack
Backup Battery Life	10 hours*
Input Point (DI)	1 point
Output Point (DO)	1 point; Max load: 250V @ 5A
Operating Temperature	-10°C to 45°C (14°F to 113°F)
Operating Humidity	Up to 85% non-condensing
Dimensions	111mm x 91mm x 29mm

\*Note: Actual battery life may vary due to usage, environment, and settings.

### Ordering Information

DIO-52-AC-ZW DI/DO Module, using AC power source.